

Title Number : BK420710

This title is dealt with by HM Land Registry, Gloucester Office.

The following extract contains information taken from the register of the above title number. A full copy of the register accompanies this document and you should read that in order to be sure that these brief details are complete.

Neither this extract nor the full copy is an 'Official Copy' of the register. An official copy of the register is admissible in evidence in a court to the same extent as the original. A person is entitled to be indemnified by the registrar if he or she suffers loss by reason of a mistake in an official copy.

This extract shows information current on 15 APR 2020 at 17:02:31 and so does not take account of any application made after that time even if pending in HM Land Registry when this extract was issued.

REGISTER EXTRACT

Title Number	: BK420710
Address of Property	: Wexham Court Playground, The Cherries, Slough
Price Stated	: Not Available
Registered Owner(s)	: WEXHAM COURT PARISH COUNCIL of 44 Norway Drive, Wexham, Slough, Berkshire SL2 5QW and of Wexham Court Parish Council, Wexham Parish Hall, Norway Drive, Wexham, Slough, Berkshire.
Lender(s)	: None

Title number BK420710

This is a copy of the register of the title number set out immediately below, showing the entries in the register on 15 APR 2020 at 17:02:31. This copy does not take account of any application made after that time even if still pending in HM Land Registry when this copy was issued.

This copy is not an 'Official Copy' of the register. An official copy of the register is admissible in evidence in a court to the same extent as the original. A person is entitled to be indemnified by the registrar if he or she suffers loss by reason of a mistake in an official copy. If you want to obtain an official copy, the HM Land Registry web site explains how to do this.

A: Property Register

This register describes the land and estate comprised in the title. Except as mentioned below, the title includes any legal easements granted by the registered lease but is subject to any rights that it reserves, so far as those easements and rights exist and benefit or affect the registered land.

SLOUGH

- 1 (15.01.2008) The Leasehold land shown edged with red on the plan of the above title filed at the Registry and being Wexham Court Playground, The Cherries, Slough.
- 2 (15.01.2008) Short particulars of the lease(s) (or under-lease(s)) under which the land is held:
Date : 14 November 2007
Term : From and including 1 April 2007 to and including 31 March 2032
Parties : (1) Slough Borough Council
(2) Wexham Court Parish Council
- 3 (15.01.2008) There are excepted from the effect of registration all estates, rights, interests, powers and remedies arising upon, or by reason of, any dealing made in breach of the prohibition or restriction against dealings therewith inter vivos contained in the Lease.
- 4 (15.01.2008) The title includes any legal easements referred to in clause LR11.1 of the registered lease but is subject to any rights that are granted or reserved by the lease and affect the registered land.
- 5 (15.01.2008) By transfers of adjoining or neighbouring land pursuant to Chapter 1 of Part 1 of the Housing Act 1980 or Part V of the Housing Act 1985 the land in this title has the benefit of and is subject to the easements and other rights prescribed by paragraph 2 of Schedule 2 of the Housing Act 1980 or Schedule 6 of the Housing Act 1985.
- 6 (15.01.2008) The landlord's title is registered.

B: Proprietorship Register

This register specifies the class of title and identifies the owner. It contains any entries that affect the right of disposal.

Title absolute

- 1 (15.01.2008) PROPRIETOR: WEXHAM COURT PARISH COUNCIL of 44 Norway Drive, Wexham, Slough, Berkshire SL2 5QW and of Wexham Court Parish Council, Wexham Parish Hall, Norway Drive, Wexham, Slough, Berkshire.

C: Charges Register

This register contains any charges and other matters that affect the land.

Title number BK420710

- 1 (15.01.2008) The land is subject to rights of drainage and rights in respect of water, gas and electricity supply services.

End of register

HM Land Registry

Current title plan

Title number **BK420710**
Ordnance Survey map reference **SU9881SE**
Scale **1:1250**
Administrative area **Slough**

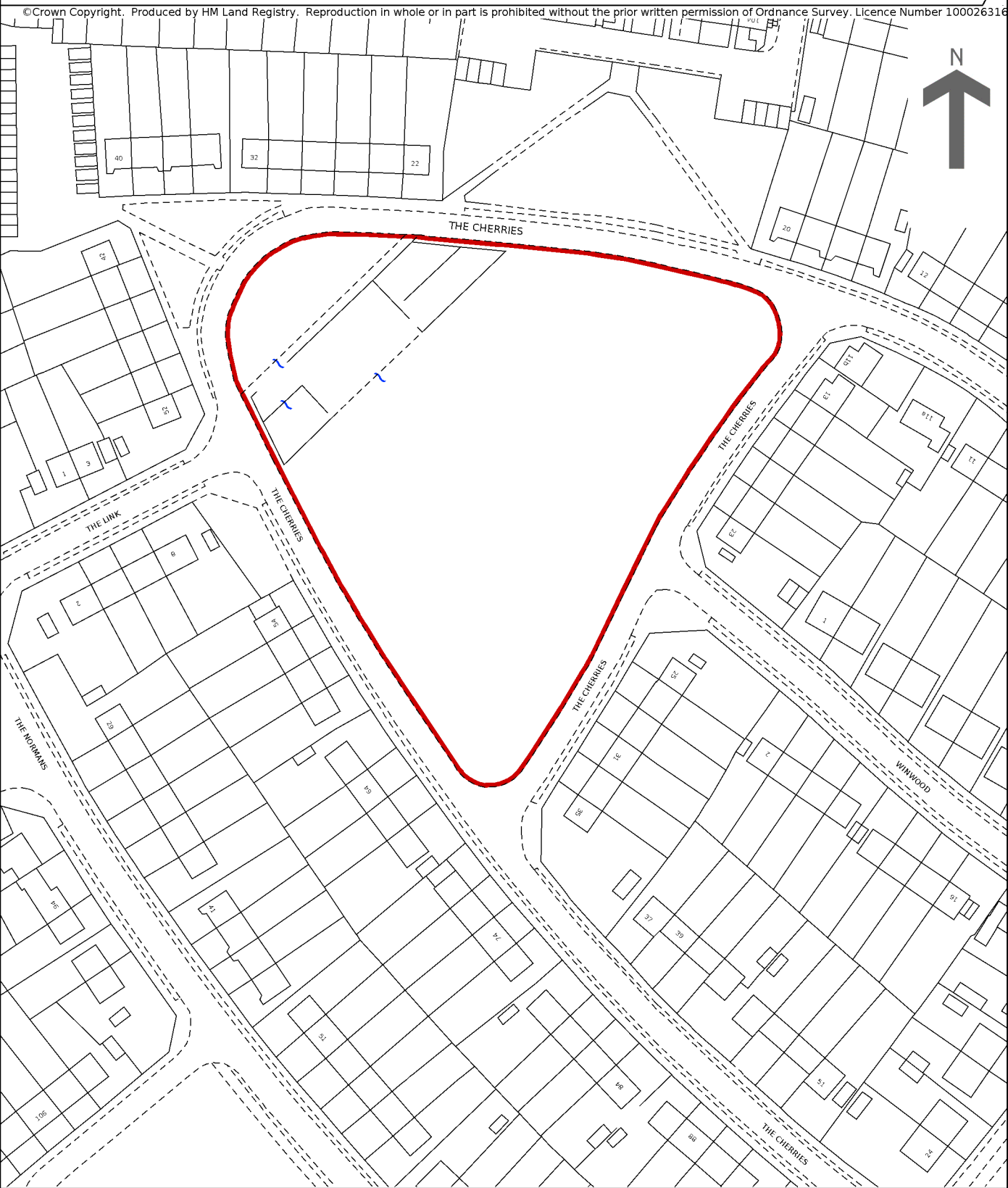
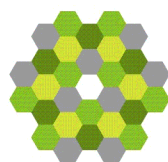

This is a copy of the title plan on 15 APR 2020 at 17:02:31. This copy does not take account of any application made after that time even if still pending in HM Land Registry when this copy was issued.

This copy is not an 'Official Copy' of the title plan. An official copy of the title plan is admissible in evidence in a court to the same extent as the original. A person is entitled to be indemnified by the registrar if he or she suffers loss by reason of a mistake in an official copy. If you want to obtain an official copy, the HM Land Registry web site explains how to do this.

HM Land Registry endeavours to maintain high quality and scale accuracy of title plan images. The quality and accuracy of any print will depend on your printer, your computer and its print settings. This title plan shows the general position, not the exact line, of the boundaries. It may be subject to distortions in scale. Measurements scaled from this plan may not match measurements between the same points on the ground.

This title is dealt with by HM Land Registry, Gloucester Office.