

Title Number : BK409783

This title is dealt with by HM Land Registry, Gloucester Office.

The following extract contains information taken from the register of the above title number. A full copy of the register accompanies this document and you should read that in order to be sure that these brief details are complete.

Neither this extract nor the full copy is an 'Official Copy' of the register. An official copy of the register is admissible in evidence in a court to the same extent as the original. A person is entitled to be indemnified by the registrar if he or she suffers loss by reason of a mistake in an official copy.

This extract shows information current on 27 SEP 2019 at 10:57:24 and so does not take account of any application made after that time even if pending in HM Land Registry when this extract was issued.

REGISTER EXTRACT

Title Number	: BK409783
Address of Property	: Allotment Gardens on the north west side of, Uxbridge Road, Slough
Price Stated	: Not Available
Registered Owner(s)	: WEXHAM COURT PARISH COUNCIL of Wexham Parish Hall, Norway Drive, Slough, Berkshire SL2 5QP and of 44 Norway Drive, Slough, Berkshire SL2 5QW.
Lender(s)	: None

## Title number BK409783

This is a copy of the register of the title number set out immediately below, showing the entries in the register on 27 SEP 2019 at 10:57:24. This copy does not take account of any application made after that time even if still pending in HM Land Registry when this copy was issued.

This copy is not an 'Official Copy' of the register. An official copy of the register is admissible in evidence in a court to the same extent as the original. A person is entitled to be indemnified by the registrar if he or she suffers loss by reason of a mistake in an official copy. If you want to obtain an official copy, the HM Land Registry web site explains how to do this.

### A: Property Register

This register describes the land and estate comprised in the title.

SLOUGH

- 1 (14.12.2006) The Freehold land shown edged with red on the plan of the above title filed at the Registry and being Allotment Gardens on the north west side of, Uxbridge Road, Slough.

### B: Proprietorship Register

This register specifies the class of title and identifies the owner. It contains any entries that affect the right of disposal.

Title absolute

- 1 (14.12.2006) PROPRIETOR: WEXHAM COURT PARISH COUNCIL of Wexham Parish Hall, Norway Drive, Slough, Berkshire SL2 5QP and of 44 Norway Drive, Slough, Berkshire SL2 5QW.
- 2 (14.12.2006) The value as at 14 December 2006 was stated not to exceed £50,000.

### C: Charges Register

This register contains any charges and other matters that affect the land.

- 1 (14.12.2006) The land is subject to such restrictive covenants as may have been imposed thereon before 14 December 2006 and are still subsisting and capable of being enforced.

End of register

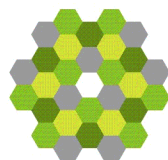

©Crown Copyright. Produced by HM Land Registry. Reproduction in whole or in part is prohibited without the prior written permission of Ordnance Survey. Licence Number 100026316

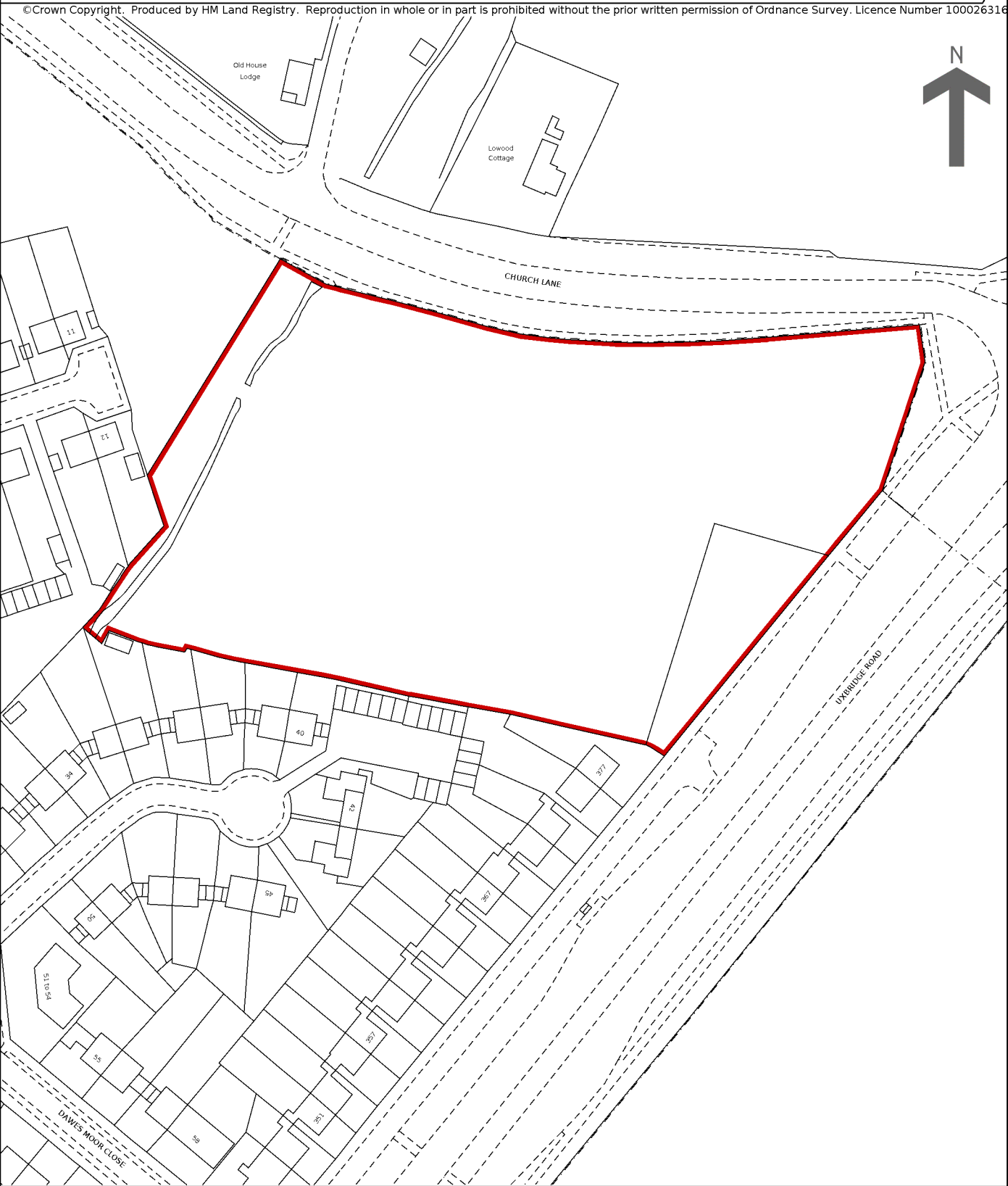

This is a copy of the title plan on 27 SEP 2019 at 10:57:24. This copy does not take account of any application made after that time even if still pending in HM Land Registry when this copy was issued.

This copy is not an 'Official Copy' of the title plan. An official copy of the title plan is admissible in evidence in a court to the same extent as the original. A person is entitled to be indemnified by the registrar if he or she suffers loss by reason of a mistake in an official copy. If you want to obtain an official copy, the HM Land Registry web site explains how to do this.

HM Land Registry endeavours to maintain high quality and scale accuracy of title plan images. The quality and accuracy of any print will depend on your printer, your computer and its print settings. This title plan shows the general position, not the exact line, of the boundaries. It may be subject to distortions in scale. Measurements scaled from this plan may not match measurements between the same points on the ground.

This title is dealt with by HM Land Registry, Gloucester Office.